



**WALRUS**  
PUMP

# TQ Series

## Electronic Control Pump



### **Walrus America Inc.**

20220 Hempstead Road, Suite #30, Houston, TX 77065

Phone: 281-955-8035 Fax: 281-955-8037

Web: [www.walrusamerica.com](http://www.walrusamerica.com)

# TQ Series Electronic Control Pump

**60 Hz**

Power: 2 - 5 HP

Head: Up to 72 psi

Flow: Up to 71.3 GPM

Outlet: 1.5" - 2"

Inlet: 1.5" - 2"



## Applications

The TQ series pumps are designed for water supply and pressure boosting in residential, commercial and light industrial applications where low or inadequate water pressure exists. It is suitable for boosting pressure from underground or surface water supplies.

## Suitable liquids

Potable water or other clean or non-corrosive liquids.

## Operating Conditions

- Ambient temperature: Max. +104 °F (40°C)
- Liquid temperature: + 39 °F (4°C) ~ +104 °F (40°C)
- System pressure: Max. 120 PSI
- Relative humidity: Max. 85% (RH)

Under normal operation, it is not necessary to adjust the pressure unless the cut in pressure is higher than preset activation point (refer to specification).

## Product code



## Product Features

- The TQ is a complete, all-in-one unit, consisting of pump, motor, pressure tank, and electronic controller. The builtin electronic controller provides constant pressure which ensures that the pump starts automatically when water is consumed and operates continuously until water is not required.
- Compact design and quiet operation make the TQ series suitable for many applications.
- The TQ is constructed from the top quality corrosion resistant materials.
- Pump has built in dry-run shut off with automatic reset function.
- The motor has built-in thermal overload to protect against high operating temperatures and over current. (Single phase motor only)
- The TQ has an anti-cycling feature which prevents the pump from continuous starting and stopping when you have a dripping tap or minor leak in the system.
- The pumps will lift water up to 25 ft. with foot valve and pump suction piping filled with water.

## Dimensions (in.)

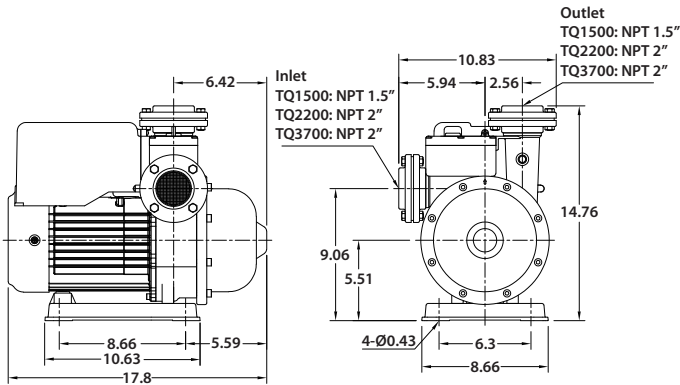

## Materials

Part Name	TQ1500/2200/3700
Pump casing	Glass filled noryl
Filling plug	SUS 304
Outlet & Inlet	SUS 304
Intermediate chamber	SUS 304
Impeller	SUS 304
Mechanical seal	Carbon+SiC+Viton
Shaft	S45C+SUS 316
Motor shell	Aluminum alloy

## Performance Curve

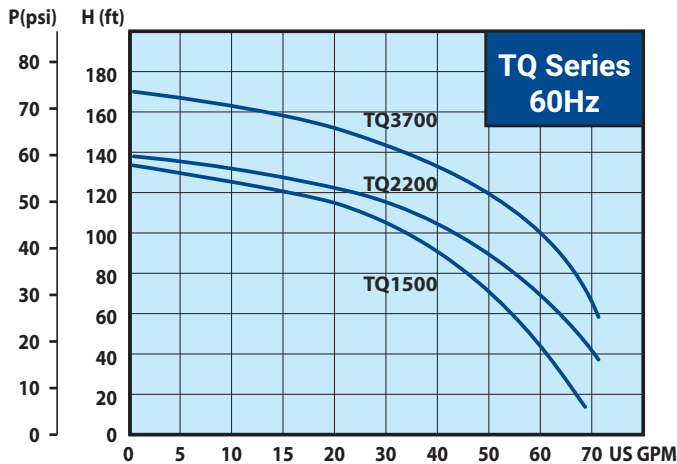

## Suction Lift Performance Table

Model	Discharge pressure psi	Flow capacity with suction lift GPM					
		0'	5'	10'	15'	20'	25'
TQ1500	10	66.2	65.0	63.7	62.0	60.2	58.1
	20	58.2	57.0	55.3	53.7	51.7	49.0
	30	50.0	47.3	44.3	41.8	39.7	37.2
	40	38.2	35.7	32.5	29.0	24.8	20.0
TQ2200	10	69.0	69.0	68.7	67.8	66.7	65.3
	20	65.8	64.4	62.8	61.2	59.3	57.2
	30	58.0	55.9	53.3	50.5	47.2	43.5
	40	45.0	41.2	37.6	34.1	30.0	24.6
TQ3700	10	70.9	70.4	70.0	69.5	69.2	68.7
	20	68.9	68.5	68.2	67.9	67.3	66.2
	30	66.7	65.5	64.2	62.8	61.3	59.8
	40	60.4	58.5	56.5	54.3	51.9	48.8
	50	50.0	46.6	42.8	39.0	35.8	32.6
	60	34.0	30.4	25.8	20.0	12.7	5.7

Note - The total system pressure is:  
"the inlet supply pressure + max pump boost pressure."



## TQ Series 60Hz

Model	Power HP	Cycle Hz	Phase Ø	Volt V	Amp's A	Inlet NPT	Outlet NPT	Preset activation pressure psi	Max discharge pressure psi	Q max. GPM	Faucet	N.W. lbs
TQ1500	2	60	1 or 3	230	9.5 or 6.5	1.5"	1.5"	43	58	66.0	15	62.8
TQ2200	3	60	3	230	9.5	2"	2"	43	60	71.3	15	68.3
TQ3700	5	60	3	230	12.0	2"	2"	43	72	71.3	15	74.4

- Assuming an average delivery of 2 GPM per tap and a 20 psi discharge pressure.



**WALRUS**  
PUMP

## Walrus America Inc.

20220 Hempstead Road, Suite #30, Houston, TX 77065

Phone: 281-955-8035

Fax: 281-955-8037

Web: [www.walrusamerica.com](http://www.walrusamerica.com)



All specifications are subject to change without notice. TQ-US012-202403

