



**WALRUS**

**MULTISTAGE CENTRIFUGAL PUMP**

# **Immersible Pumps**

## **TPHK 2/4/8/12T 60Hz**



**Walrus America Inc**

**ISO 9001 Certified**



### Applications

The WALRUS TPHK Series is vertical multistage centrifugal pump, designed for industrial use, specially for machine tools. It is suitable to carry fluids such as water, coolant, light oil and other clean, non aggressive matters for:

- Industrial circulation system
- Washing/cleaning system
- Filtration system

### Pumps

Submersible vertical multistage centrifugal pump, self-priming, one straight shaft between motor and pump, impellers mounted on extended motor shaft. Main working parts made by stainless steel.

### Motors

Nominal speed :3500 rpm at 60Hz  
 Standard voltage : 3 phase : 230 / 460V  
 Protection class: IP54  
 Insulation class: F.

### Operating Limits

Ambient temperature :Max. 104°F (40°C)  
 Liquid temperature range :32°F (0°C) to 194°F (90°C)  
 Flow: 10 GPM to 75 GPM  
 Head: 20ft to 280ft  
 Operating pressure :Max. 142 psi  
 Submerged depth :Min. 2.6"

### Product code

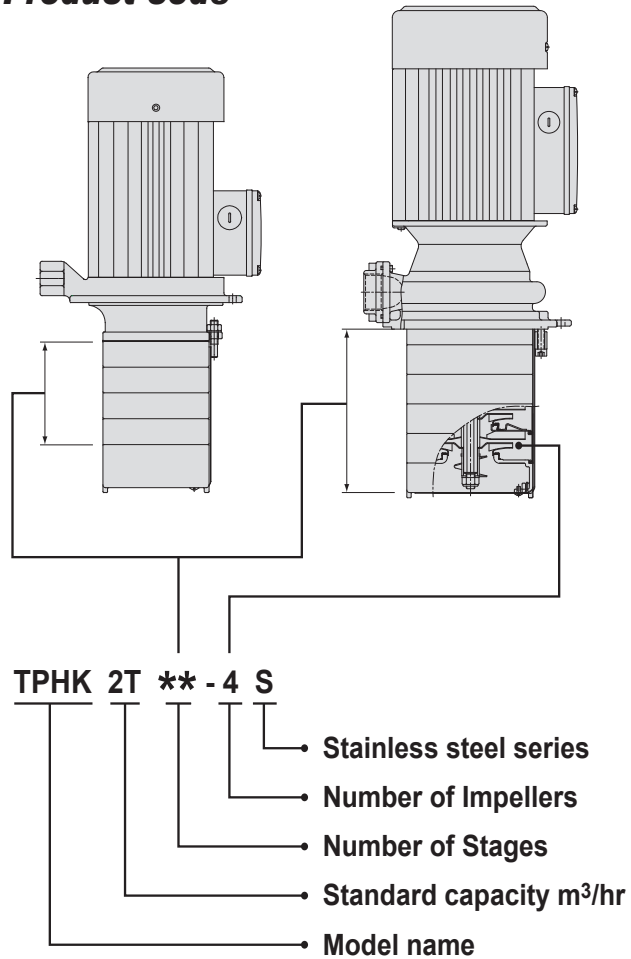

### Performance curves

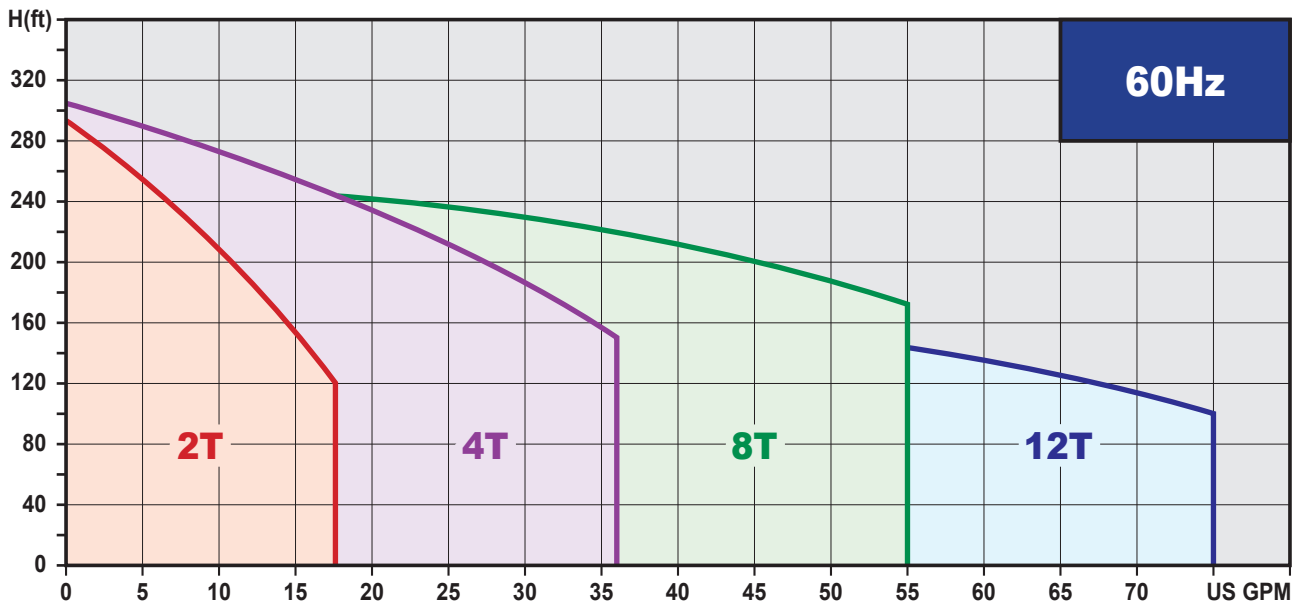

## Performance curves

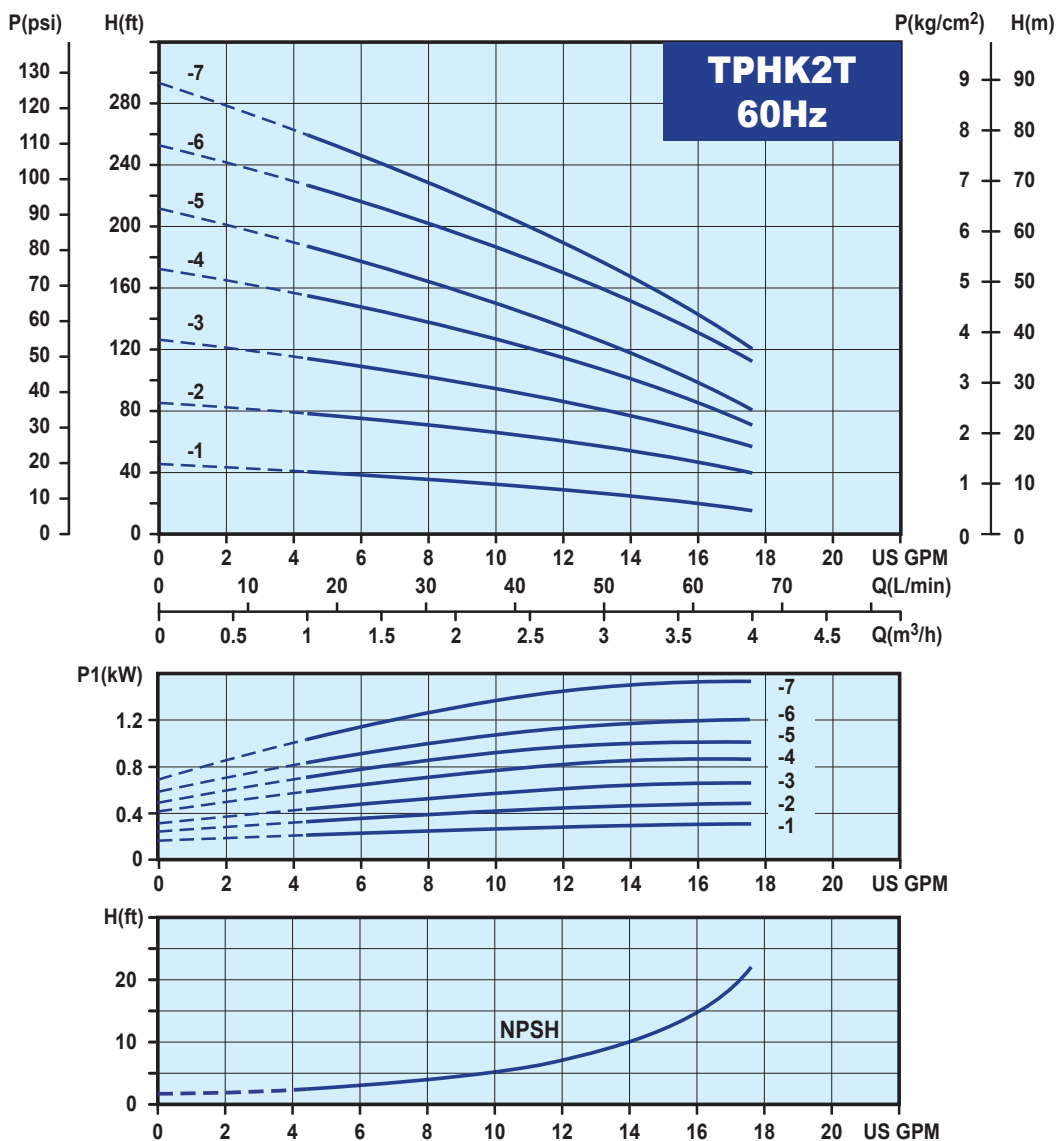

## Electrical data, 3Ø 60Hz , 3500rpm

Model	Power (HP)	S.F.	Volts (V)	Ampere (A)
TPHK 2T ** -1	½	1.9	230 / 460	3.1 / 1.6
TPHK 2T ** -2	½	1.9	230 / 460	3.1 / 1.6
TPHK 2T ** -3	½	1.9	230 / 460	3.1 / 1.6
TPHK 2T ** -4	½	1.9	230 / 460	3.1 / 1.6
TPHK 2T ** -5	¾	1.9	230 / 460	4.2 / 2.1
TPHK 2T ** -6	¾	1.9	230 / 460	4.2 / 2.1
TPHK 2T ** -7	1	1.9	230 / 460	5.2 / 2.6

\*\* = Number of Stages, maximum 11 stages.



## Performance curves

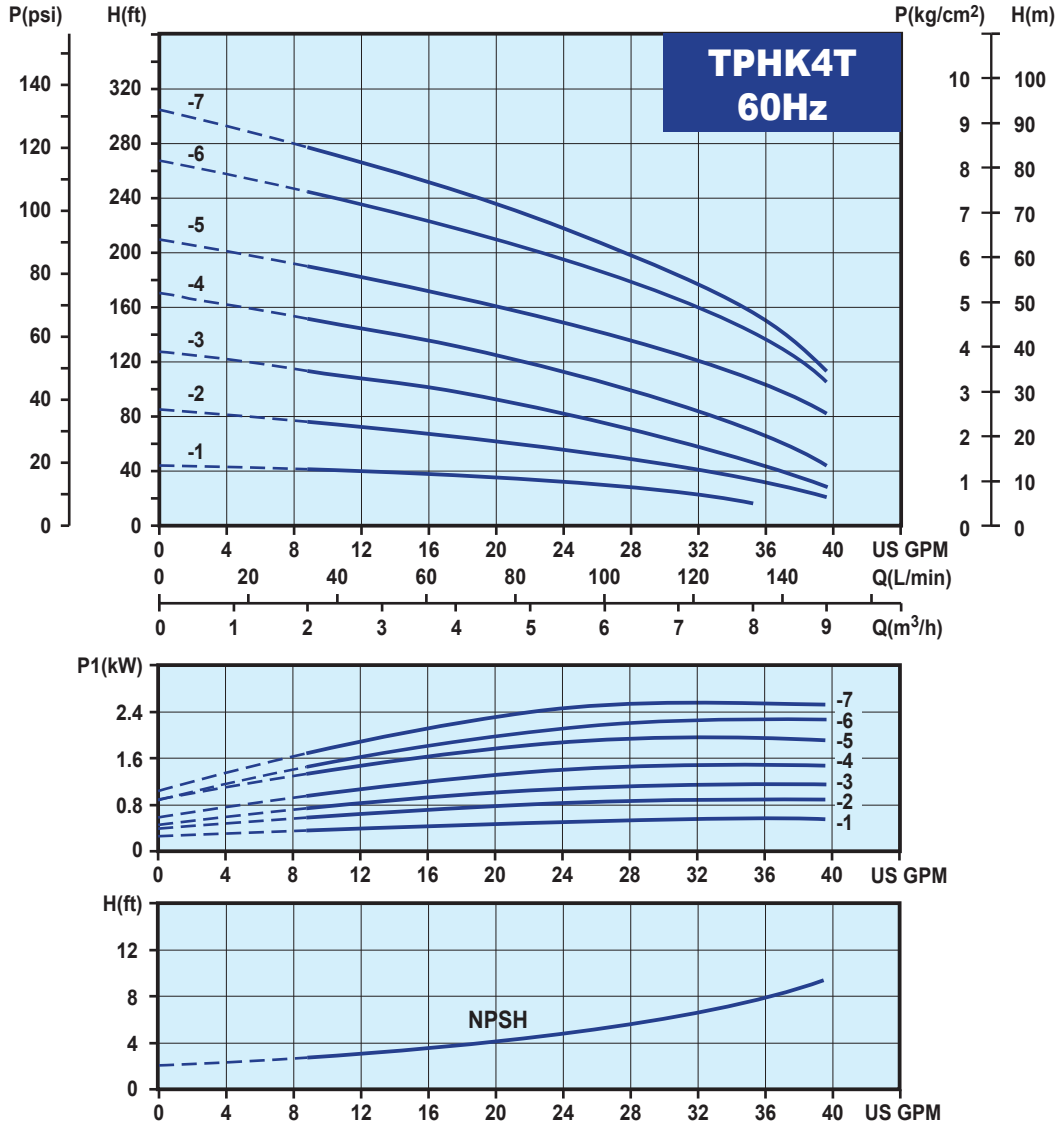

## Electrical data, 3Ø 60Hz , 3500rpm

Model	Power (HP)	S.F.	Volts (V)	Ampere (A)
TPHK 4T ** -1	½	1.9	230 / 460	3.1 / 1.6
TPHK 4T ** -2	½	1.9	230 / 460	3.1 / 1.6
TPHK 4T ** -3	¾	1.9	230 / 460	4.2 / 2.1
TPHK 4T ** -4	1	1.9	230 / 460	5.2 / 2.6
TPHK 4T ** -5	1½	1.5	230 / 460	7.4 / 3.7
TPHK 4T ** -6	2	1.9	230 / 460	11.6 / 5.8
TPHK 4T ** -7	2	1.9	230 / 460	11.6 / 5.8

\*\* = Number of Stages, maximum 8 stages.

## Performance curves

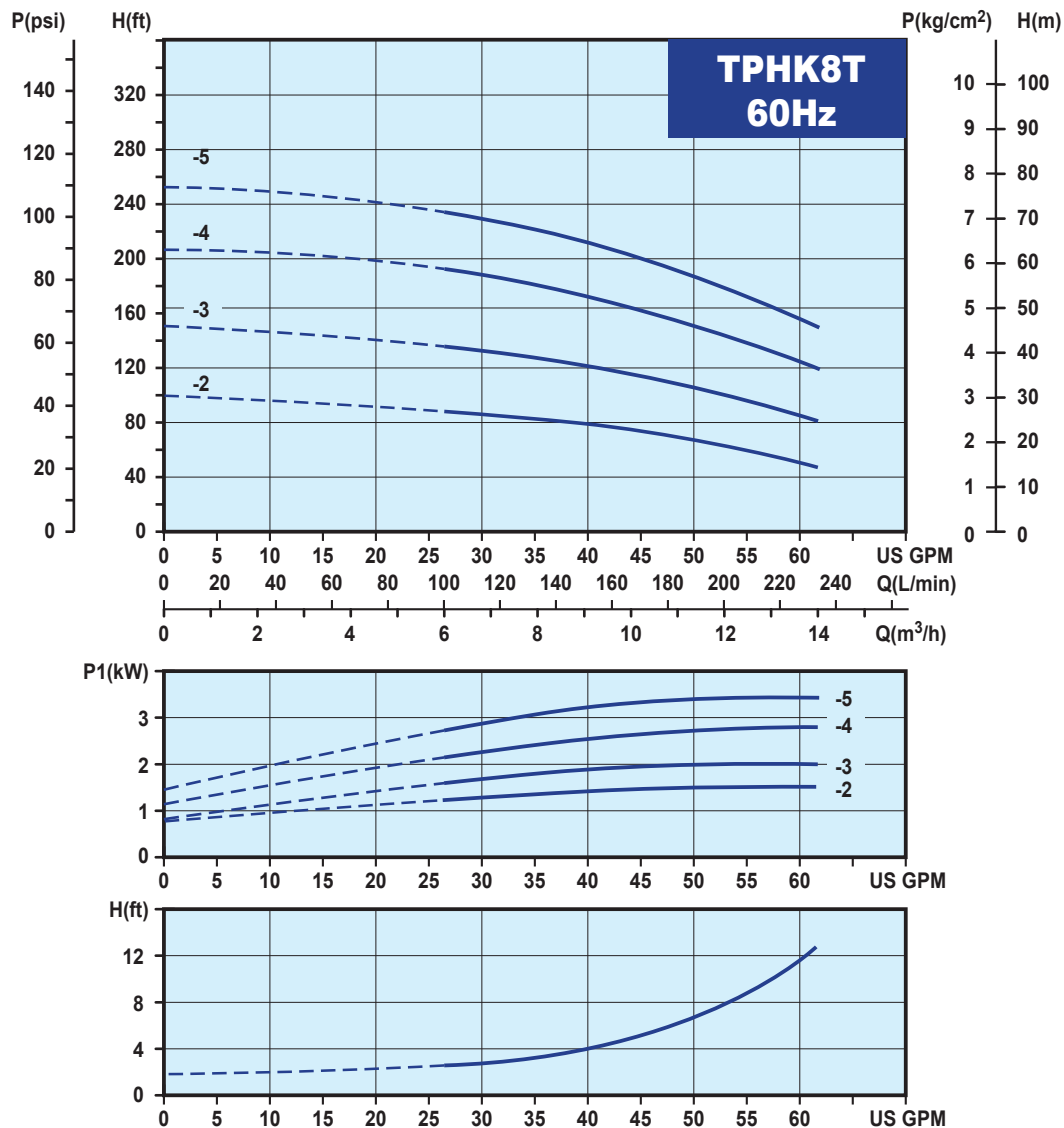

## Electrical data, 3Ø 60Hz , 3500rpm

Model	Power (HP)	S.F.	Volts (V)	Ampere (A)
TPHK 8T ** -2	1½	1.6	230 / 460	7.4 / 3.7
TPHK 8T ** -3	1½	1.6	230 / 460	7.4 / 3.7
TPHK 8T ** -4	3	1.5	230 / 460	12.6 / 6.3
TPHK 8T ** -5	3	1.5	230 / 460	12.6 / 6.3

\*\* = Number of Stages, maximum 9 stages.

## Performance curves

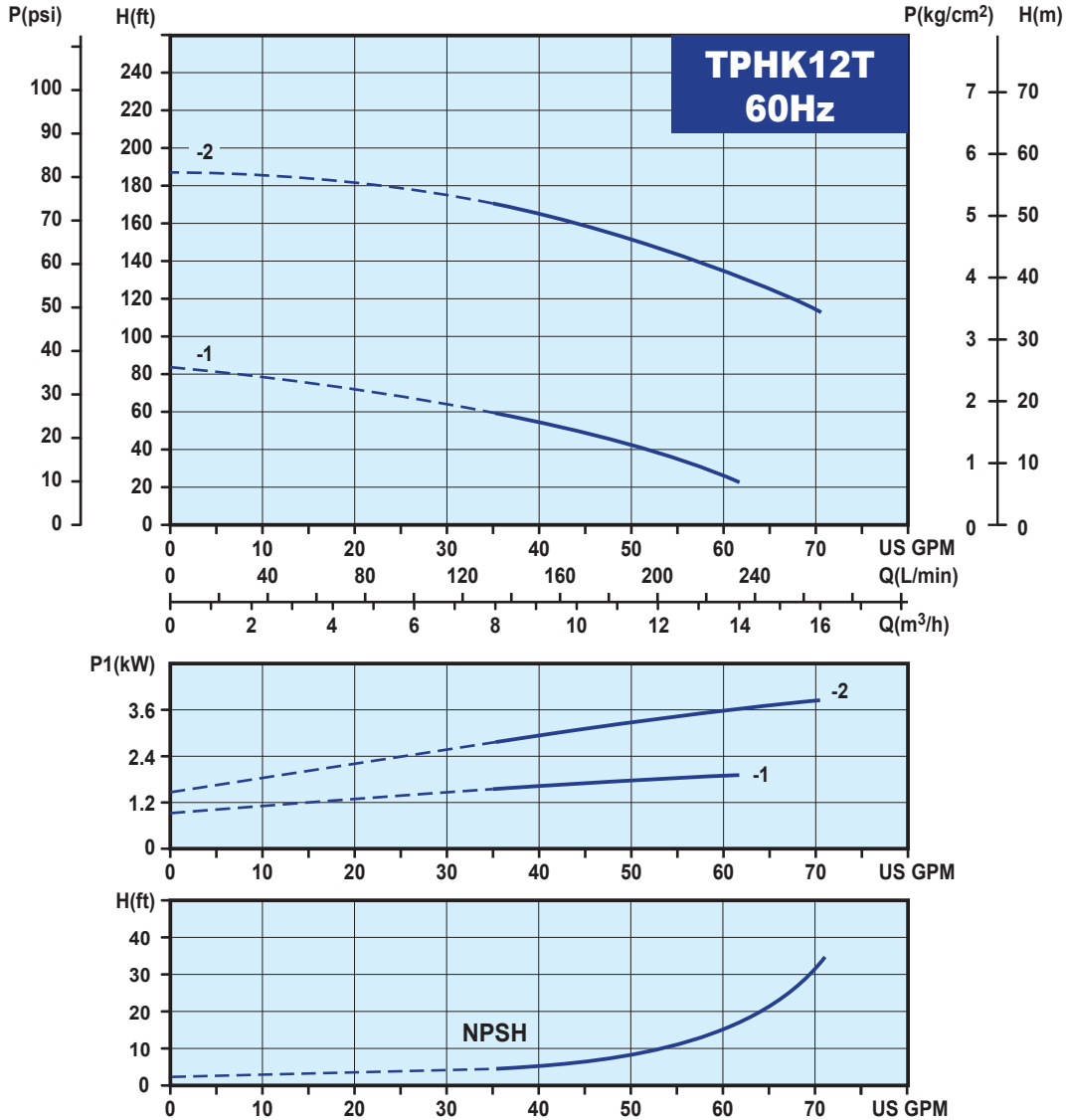

## Electrical data, 3Ø 60Hz , 3500rpm

Model	Power (HP)	S.F.	Volts (V)	Ampere (A)
TPHK 12T ** -1	1½	1.6	230 / 460	7.4 / 3.7
TPHK 12T ** -2	3	1.5	230 / 460	12.6 / 6.3

\*\*= Number of Stages, maximum 9 stages.

## TPHK 2T/4T

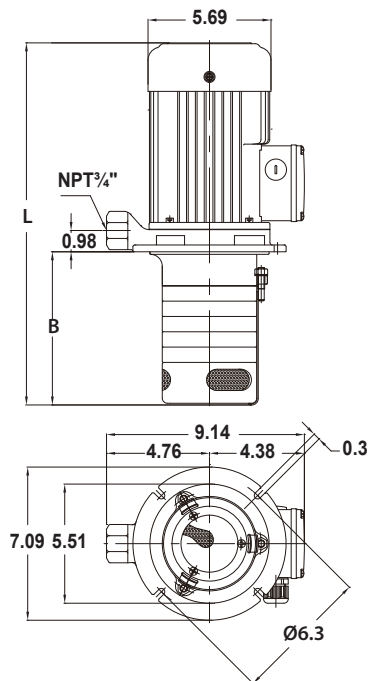

## TPHK 8T/12T

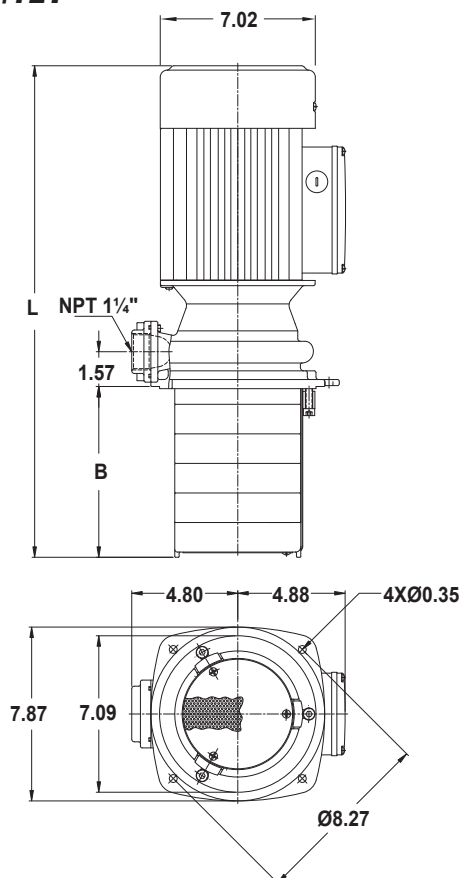

## Dimensions and Weights

Model	B (in.)	L (in.)	N.W.(lbs)
TPHK 2T 3 -1	5.67	13.76	24.0
TPHK 2T 8 -1	9.21	17.30	26.2
TPHK 2T 3 -2	5.67	13.76	24.5
TPHK 2T 5 -2	7.09	15.18	25.4
TPHK 2T 9 -2	9.92	18.01	27.1
TPHK 2T 3 -3	5.67	13.76	24.7
TPHK 2T 4 -3	6.38	14.47	25.1
TPHK 2T 5 -3	7.09	15.18	25.6
TPHK 2T 6 -3	7.79	15.89	26.0
TPHK 2T 8 -3	9.21	17.30	26.9
TPHK 2T11-3	11.34	19.43	27.8
TPHK 2T 4 -4	6.38	14.47	25.4
TPHK 2T 6 -4	7.79	15.89	26.2
TPHK 2T 5 -5	7.09	16.75	28.0
TPHK 2T 6 -5	7.79	17.46	29.3
TPHK 2T 6 -6	7.79	17.78	29.8
TPHK 2T 8 -6	9.21	19.19	30.6
TPHK 2T 9 -6	9.92	19.90	31.1
TPHK 2T10-6	10.63	20.61	31.3
TPHK 2T11-6	11.34	21.32	31.7
TPHK 2T 7 -7	8.50	18.48	28.7
TPHK 4T 2 -1	5.67	13.76	23.8
TPHK 4T 3 -1	6.73	14.82	24.3
TPHK 4T 2 -2	5.67	13.76	24.3
TPHK 4T 3 -2	6.73	14.82	24.7
TPHK 4T 4 -2	7.79	15.89	25.1
TPHK 4T 6 -2	9.92	18.01	25.6
TPHK 4T 3 -3	6.73	16.40	25.8
TPHK 4T 4 -3	7.79	17.46	26.2
TPHK 4T 5 -3	8.86	18.52	26.7
TPHK 4T 6 -3	9.92	19.59	27.1
TPHK 4T 8 -3	12.05	21.71	28.0
TPHK 4T 4 -4	7.79	17.46	29.3
TPHK 4T 5 -4	8.86	18.52	29.8
TPHK 4T 6 -4	9.92	19.59	30.2
TPHK 4T 5 -5	8.86	18.52	30.6
TPHK 4T 8 -5	12.05	21.71	32.0
TPHK 4T 6 -6	9.92	21.08	31.1
TPHK 4T 8 -6	12.05	23.21	32.2
TPHK 4T 7 -7	10.98	22.15	32.2
TPHK 4T 8 -7	12.05	23.21	32.6
TPHK 8T 6 -2	7.74	22.26	52.9
TPHK 8T 9 -2	11.75	26.28	55.8
TPHK 8T 3 -3	3.72	18.25	50.7
TPHK 8T 6 -3	7.74	22.26	53.6
TPHK 8T 9 -3	11.75	26.28	56.4
TPHK 8T 4 -4	5.06	19.59	59.5
TPHK 8T 6 -4	7.74	22.26	61.7
TPHK 8T 5 -5	6.40	20.93	61.7
TPHK12T 6 -1	7.83	22.36	59.5
TPHK12T 6 -2	7.83	22.36	63.9
TPHK12T 9 -2	11.75	26.28	67.2

## Sectional drawing

TPHK 2T/4T

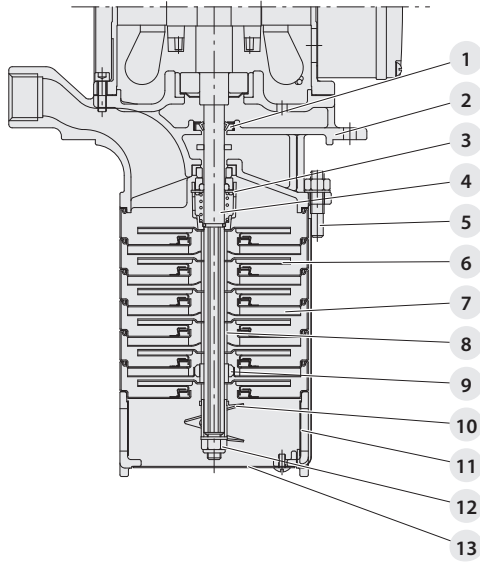

TPHK 8T/12T

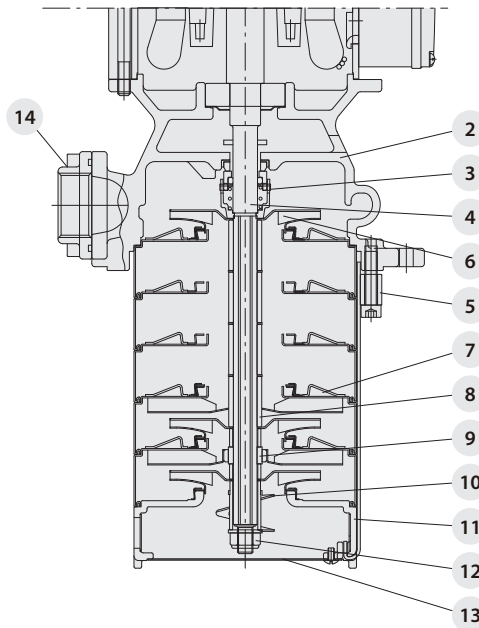

## Materials

NO.	Part name	Material	
		Standard	S series
1	Oil Seal	NBR	
2	Pump Casing	FCD 45	SUS 304
3	Mechanical Seal	HSSV ( SiC / SiC / Viton )	
4	Shaft	SUS 304	
5	Strap	SUS 304	
6	Impeller	SUS 304	
7	Intermediate chamber	SUS 304	
8	Sleeve	SUS 304	
9	Bearing	2T / 4T : SiC 8T/12T : Tungsten carbide	
10	Priming screw	SUS 304	
11	Suction interconnector	SUS 304	
12	Lock Nut	SUS 316	
13	Filter	SUS 304	
14	Flange	SUS 304	



## Walrus America Inc

20220 Hempstead Road, Suite #30, Houston, TX 77065

Phone: 281-955-8035 Fax: 281-955-8037

Web: [www.walrusamerica.com](http://www.walrusamerica.com)